

## Solid Handle Valve Maintenance (TFM™ TIP STYLE)

Seal service procedure for the 1/8" Angle and Inline Vent Valves, 1/4" Angle and Inline Bleed Valves, 1/2" Angle and Inline Sample Valves with Solid Handles and TFM™ Tips (press fit tip).

### DISASSEMBLY

1. Completely remove all **LOCK SCREWS** (two or three depending on size of valve) from **HANDLE** with Allen-head wrench (.050" size for vent valve and 1/16th size for bleed and sample valve) from stem seal kit.
2. Turn **HANDLE** clockwise until the **DOWEL PIN** is exposed then remove pin.
3. Grip **HANDLE** firmly and pull **STEM** out of the **VALVE BODY**.
4. Remove **STEM O-RING**.
5. Remove **TIP** with a pair of pliers by twisting and pulling lightly.

### REASSEMBLY

1. Press new **TIP** into **STEM**.
2. Slide new **O-RING** into stem **O-RING SLOT**.
3. Wet **STEM O-RING** with clean water and align **DOWEL PIN GROOVE** on stem with **DOWEL PIN HOLE** on body and install **STEM** into **VALVE BODY** until **DOWEL PIN GROOVE** is exposed in **VALVE BODY** to accept **DOWEL PIN**.
4. Insert new **DOWEL PIN** into **DOWEL PIN HOLE** in place so **STEM** cannot rotate in **VALVE BODY**.
5. Place FLT FDA approved body lubricant (PN: 6Z0009A) onto **HANDLE TRACK**.
6. Engage **HANDLE** onto **STEM** in counter-clockwise motion with light downward pressure until **HANDLE** meets **BODY SHOULDER**.
7. Install new **LOCK SCREWS**.

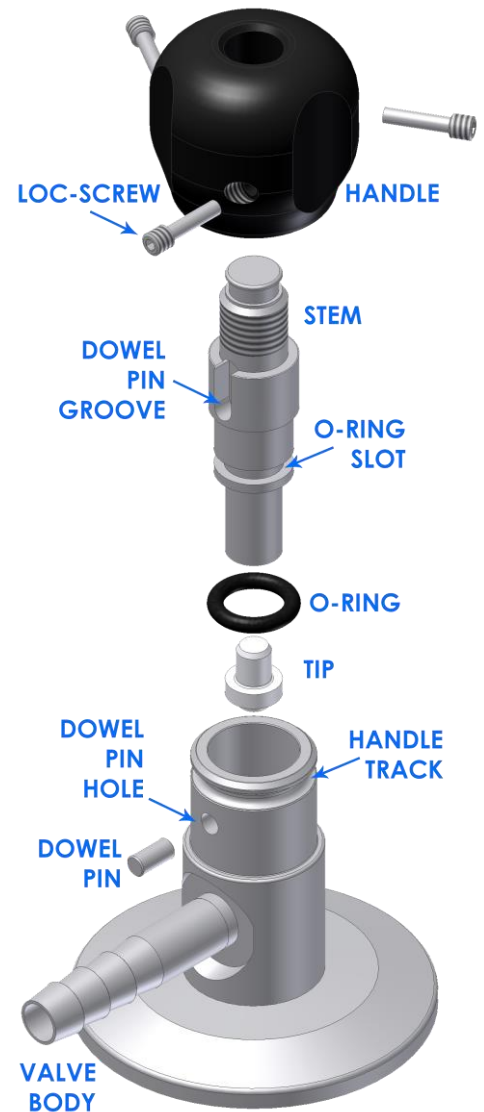

### Please Note:

- Stem Seal (TFM™ tip and O-ring) must be replaced every 6 month when valve is installed in a SIP system, and every 8-10 months when valve is installed in a CIP loop. Please consult factory for different applications.
- This is a guide and should not override any existing procedures already in place.
- TFM is a trademark of Dyneon.